

FIT Instructions

This FIT package includes:



A



B



C

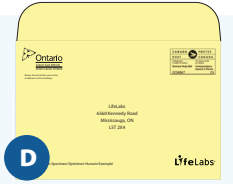

D

1. Check

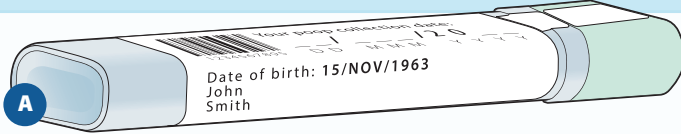

Date of birth



Your name

Is this your information? If not, call LifeLabs at 1-833-676-1426

2. Write

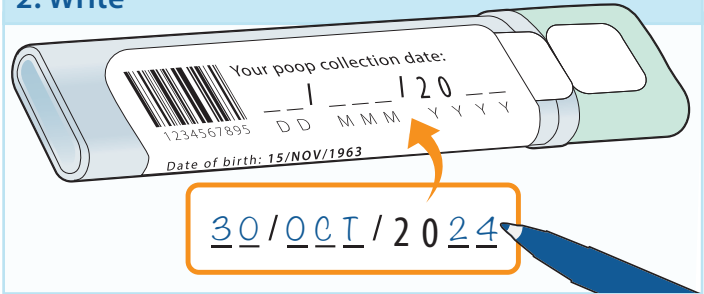

3. Pee and Flush

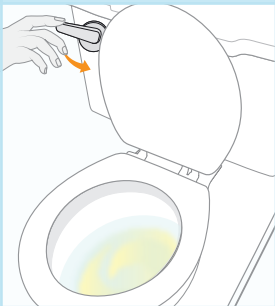

4. Prepare

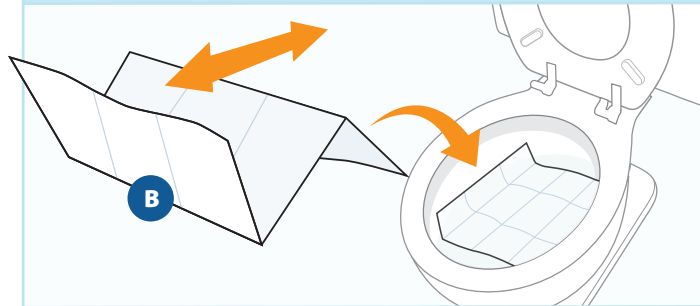

5. Poop

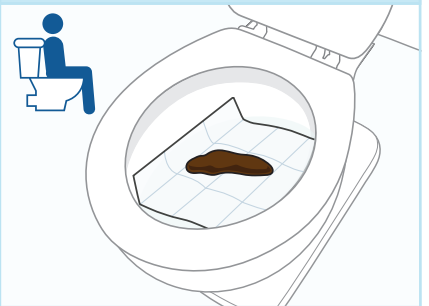

6. Collect

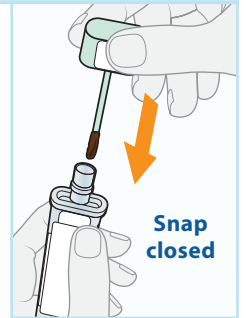
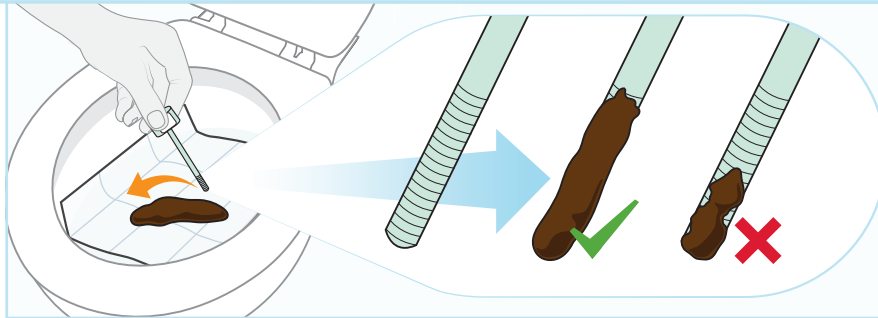
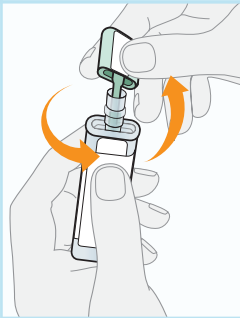

7. Flush

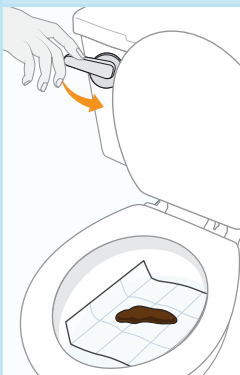

8. Drop off or Mail

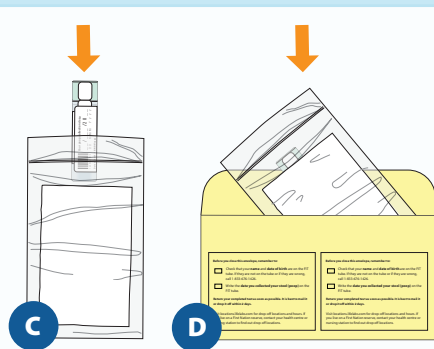

OR



OR

If you live on a First Nation reserve, contact your health centre or nursing station to discuss drop off options

Need this information in an accessible format?

1-855-460-2647 | TTY (416) 217-1815 | publicaffairs@cancercare.on.ca

Funding provided by the Ontario Ministry of Health and Long-Term Care
Adapted by Cancer Care Ontario with permission from: KAISER PERMANENTE CENTER FOR HEALTH RESEARCH
(NIH grant number: UH3 CA188640) and the UCSF Health Outcomes Policy & Economics (HOPE) Research Program



Consignes pour effectuer votre TIF

Cette trousse de TIF comprend :

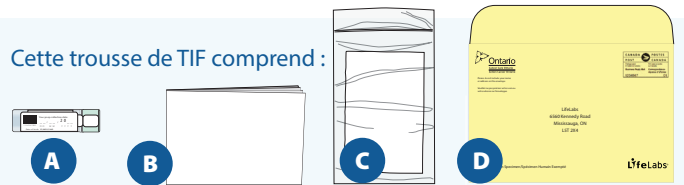

1. Vérifiez

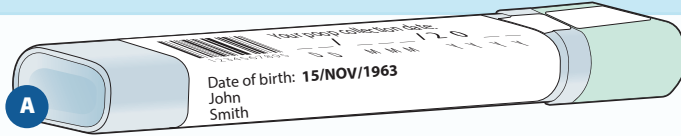

✓ **Votre date de naissance** ✓ **Votre nom**

Est-ce bien vos renseignements personnels? Si ce n'est pas le cas, téléphonez à LifeLabs au 1.833.676.1426.

2. Inscrivez la date de prélèvement



3. Urinez et tirez la chasse d'eau

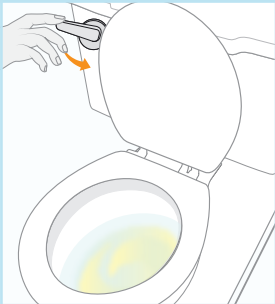

4. Préparez la cuvette

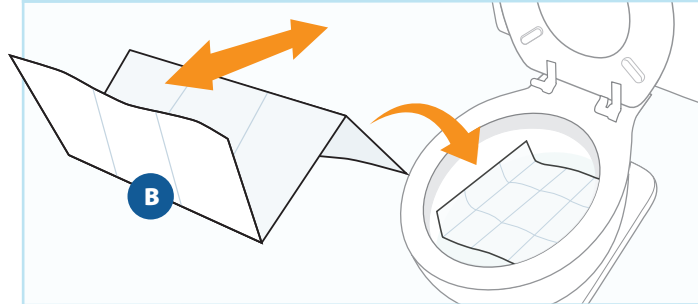

5. Faites vos selles

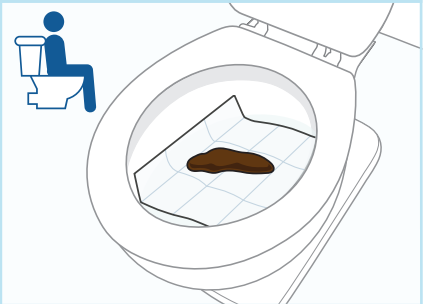

6. Recueillez un échantillon

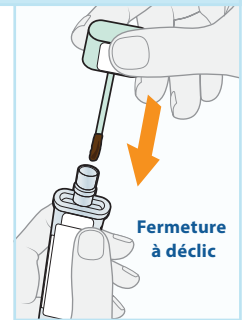
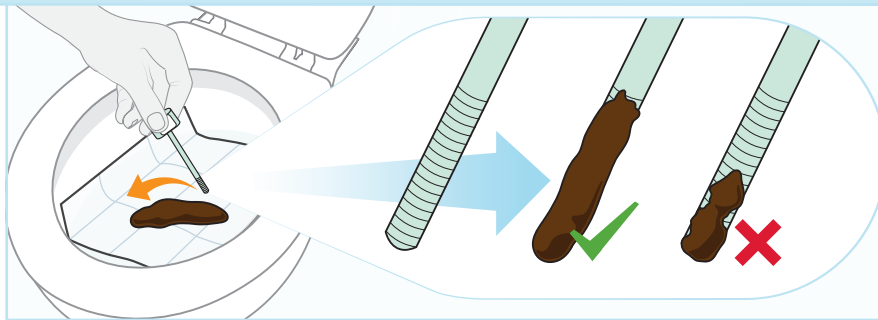
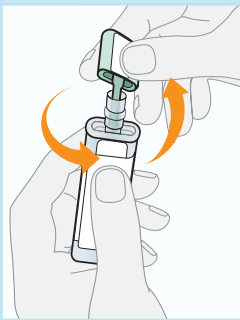

Fermeture à délic

7. Tirez la chasse d'eau

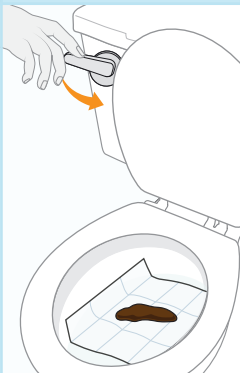

8. Déposez ou expédiez votre échantillon

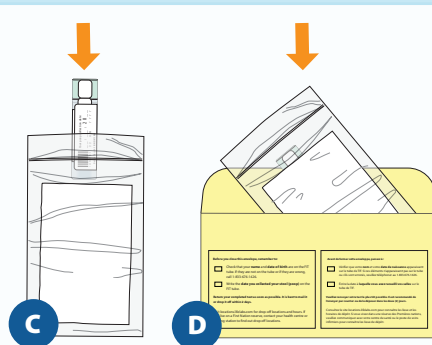

DANS LES
2
JOURS

CANADA POSTES
POST CANADA

OU

LifeLabs®
locations.lifelabs.com
OU

Si vous vivez dans une réserve des Premières nations, veuillez communiquer avec votre centre de santé ou le poste de soins infirmiers pour connaître les options de dépôt.

Vous voulez obtenir cette information dans un format accessible?

1.855.460.2647 | ATS 416.217.1815 | publicaffairs@cancercare.on.ca

Financé par le ministère de la Santé et des Soins de longue durée de l'Ontario.
Adapté par Action Cancer Ontario avec l'autorisation de : KAISER PERMANENTE CENTRE FOR HEALTH RESEARCH (numéro de subvention NIH : UH3 CA 188640) et du programme de recherche Health Outcomes Policy & Economics (HOPE) de l'UCSF

 **Ontario**
Action Cancer Ontario