

# Mga Tagubilin sa FIT

Kasama sa package ng FIT na ito ang:



A



B

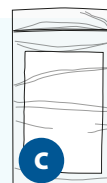

C



D

## 1. Suriin

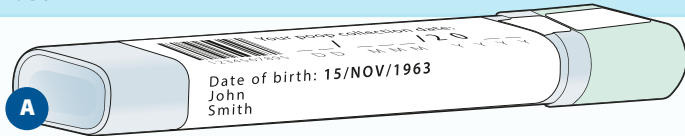

Petsa ng kapanganakan



Pangalan mo

Ito ba ang impormasyon mo? Kung hindi, tumawag sa LifeLabs sa 1-833-676-1426

## 2. Isulat

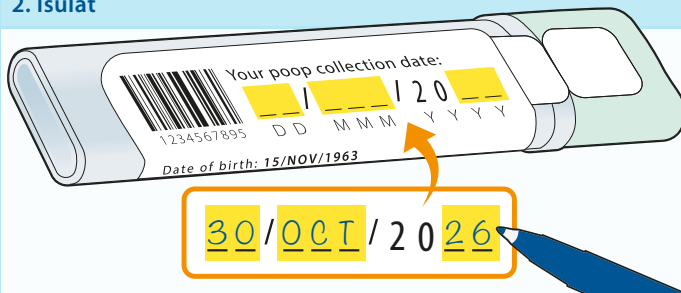

## 3. Umihi at I-flush

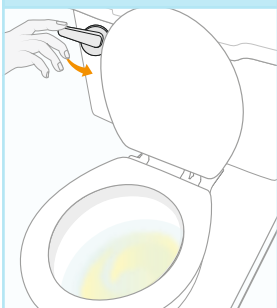

## 4. Ihanda

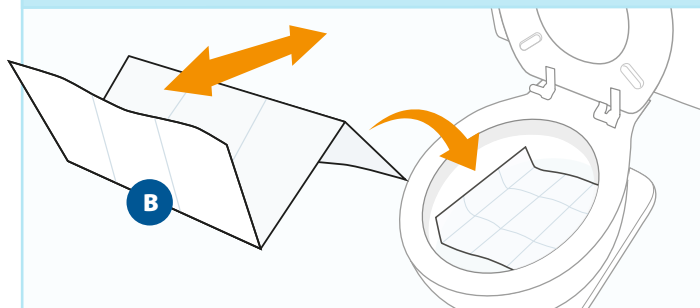

## 5. Dumumi



## 6. Kolektahin

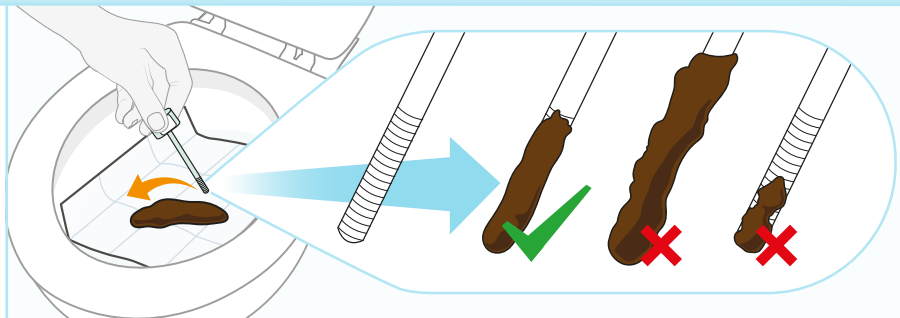
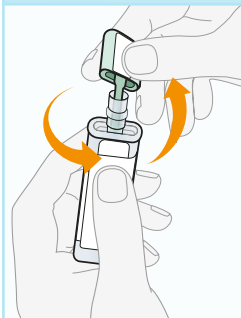

## 7. I-flush

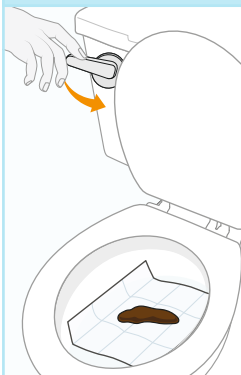

## 8. I-drop off o Ipadala

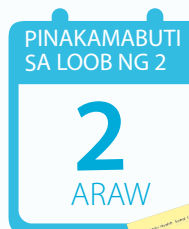
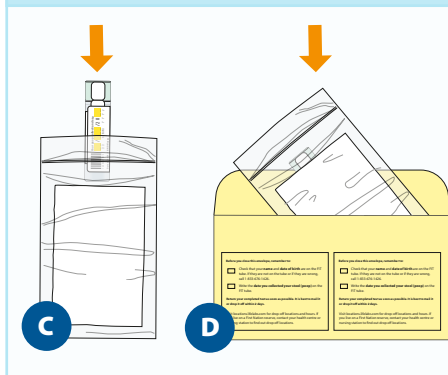

Kung nakatira ka sa isang First Nation reserve, makipag-ugnayan sa inyong health center o estasyon ng nars para talakayin ang mga opsyon sa pag-drop off

**Kailangan mo ba ang impormasyong ito sa naa-access na format?**

1-877-280-8538 | TTY 1-800-855-0511 | [info@ontariohealth.ca](mailto:info@ontariohealth.ca)



**Ontario Health**  
Cancer Care Ontario